

SEE SHEET 22.01

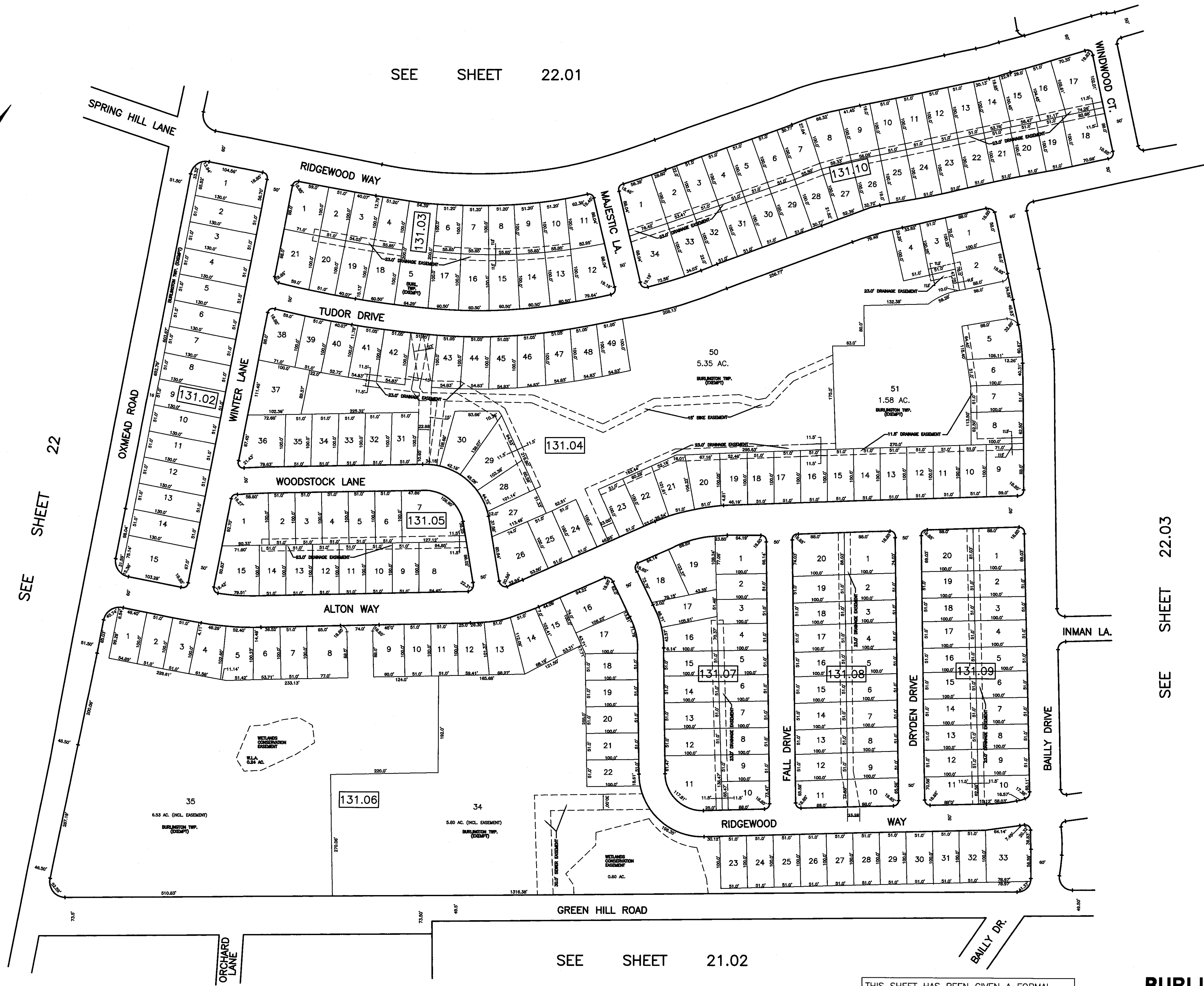
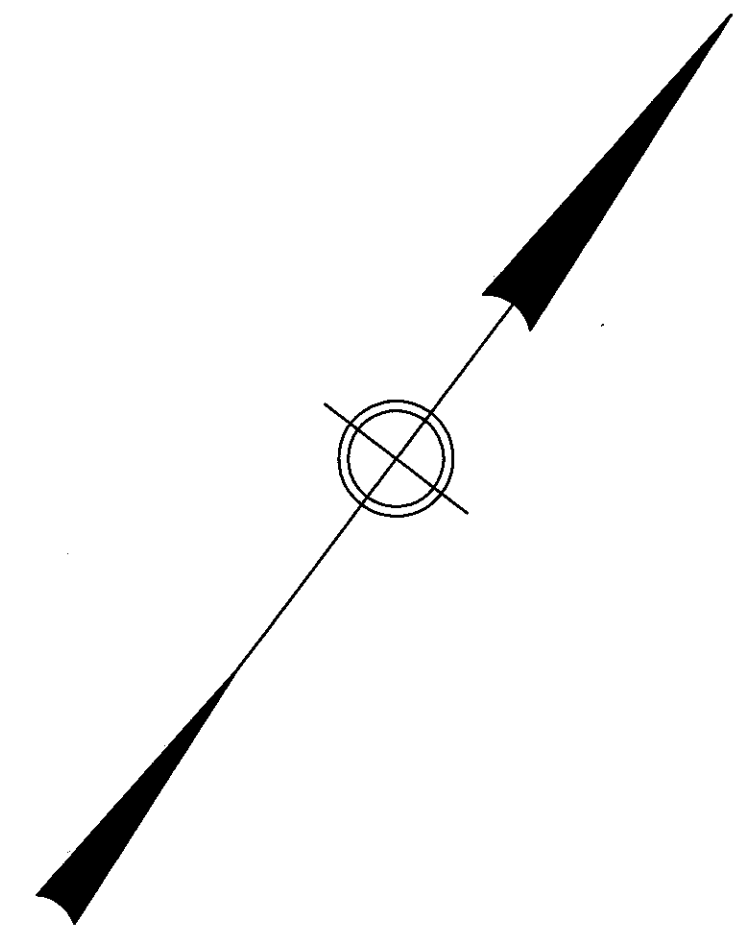

SEE SHEET 22

SEE SHEET 22.03

SEE SHEET 21.02

SEE SHEET 21

THIS SHEET HAS BEEN GIVEN A FORMAL CERTIFICATION BY THE DIVISION OF TAXATION ON JULY 11, 2005, SIGNED BY JAMES COLL AND SANTO DIDONATO ASSIGNED SERIAL NUMBER 863.

THIS SHEET IS AN AUTOCAD COMPUTER GENERATED DRAWING. THIS WAS DONE UNDER THE SUPERVISION OF T. RONALD GSELL, P.E. & P.L.S. LICENSED LAND SURVEYOR N.J. LICENSE NO. 12812 DATED NOVEMBER 22, 1989. THE APPROVED ORIGINAL IS ON FILE IN THE ENGINEER'S OFFICE.

TAX MAP

BURLINGTON TOWNSHIP

BURLINGTON COUNTY, NEW JERSEY

SCALE: 1" = 100' NOVEMBER 22, 1989

T. RONALD GSELL, P.E. & P.L.S.

200 HIGH STREET, MOUNT HOLLY, N.J.